

State of Wyoming Corner Record

(In compliance with the CORNER PERPETUATION AND FILING ACT, Wyoming Statutes, 1977,
Section 36~11~101, et seq., and the Rules and Regulations of the Board of Registration for Professional
Engineers and Professional Land Surveyors)

The reverse side of this form may be used if more space is needed.

The Record of the original survey and the citation of the source of the historical information (if the corner is lost or obliterated). The description of the corner monumentation evidence as found and/or the monument and its accessories as established to perpetuate the location of this corner. A sketch of the relative location of this Monument, accessories, and reference points with the course and distance to adjacent corner (s) (if determined during this Survey). The Method and Rationale used for the reestablishment of lost and obliterated corner.

G.L.O.:North between Sec. 27 & Sec. 28, Variation: 15°15'E, 6.00 chains to top of Lodge Pole Bluffs; 20.25chains to Old Emigrant Road at foot of Bluffs, bears E & W; 40.00 chains set Conglomerate stone 20"X14"X6" for 1/4 Sec.Cor.; 54.00 chains to Lodge Pole Creek bank; 61.00 chains To Lodge Pole Creek, dry bed 100 links wide, course E.; 70.00 chains To foot of Bluff; 80.00 chains , set Conglomerate 18"X12"X5" for corner Sections 21, 22, 27 & 28.

(Under contract by Dep. U.S. Surveyor John B. Thomas, Contract No. 9, dated 17 October 1870)

Laramie County Surveyor:C.E. Gattis, D.J Walcut & D.Licata, chain; 2 & 3 of October 1935; Found blue Granite stone marked 1/4, cor. Sec 16 & 15; Found limestone Marked III on East & I on South being corner common to Sections 27,28,33 & 34; Mea. 13248 ft., set limestone 80.3 chains N. of Sec. Cor. 27,28,33 & 34 and 80.3 chains S. of Sec. cor. 15,16,21 & 22.

Found Square Head Bolt 1" in diameter being 16" long with head being 1 1/4" across the flats at point set for proportional distance from Section Corner common to Sec. 15,16,21 & 22 and Section corner on the Twp line for Sec.33 & 34 in this Twp and Sec. 3 & 4 of T.15N. R.67W.

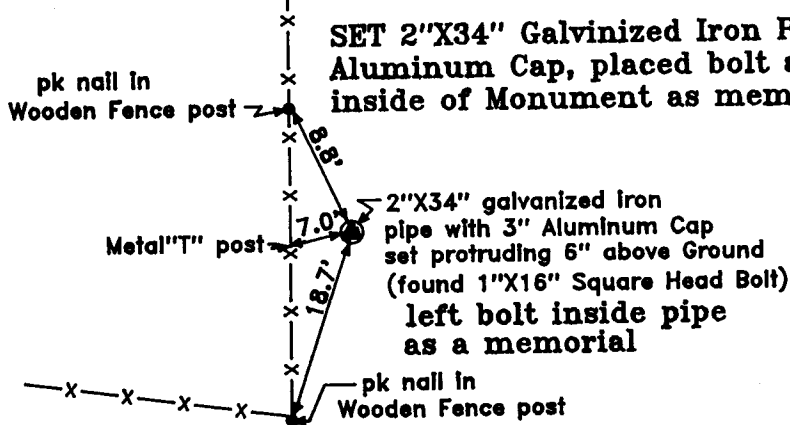

Date of Field Work: 12 August 1999

Office Reference: No. 21222829

Cross Index Diagram

T.15 N. R.67 W. 6th P.M.

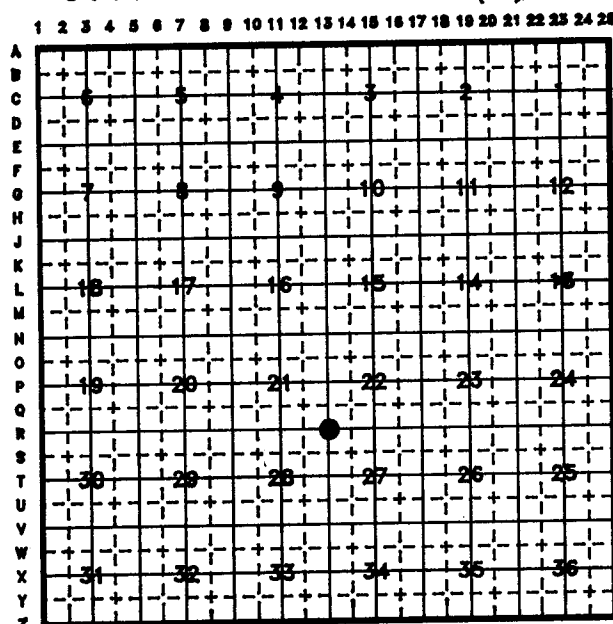

Firm/Agency, Address
Terrestrial Surveying & Mapping Co.
"Your Friendly Neighborhood Surveyor"
 1127 Terry Ranch Road
 Cheyenne, Wyoming 82007
 Telephone Number: (307) 634-9360

This Corner Record was prepared by
 me or under my direction and
 supervision.

SEAL & SIGNATURE

RECORDED 8/26/1999 AT 2:02 PM REC# 259179 BK# 1531 PG# 286
 DEBRA K. LATHROP, CLERK OF LARAMIE COUNTY, WY PAGE 1 OF 1

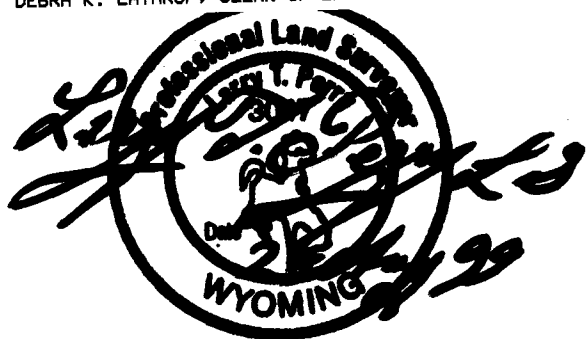

Section Corner

21	22
28	27

 Corner Name: _____ Section: _____

T.15 N. R.67 W. 6th P.M. Cross Index No. **R~13**